

CYDEEN Field work support service

Reducing workload for workers at the work site and **Improving work quality**

Field work support service such as maintenance & inspection operation for facility/equipment



Applicable Fields

Maintenance & Inspection service of facility/equipment etc.

Customer's Challenges

- Reducing workload for workers at the work site & Improving work quality
- Transfer of the knowledge and skills from an expert



Our Solution

- By making good use of a tablet, workload will be reduced to printing document, capturing evidence photo, and creating a report
- Quick problem resolution by sharing image and video picture with control-administrator
- Obtain know-how at work site by video training materials and improving work quality

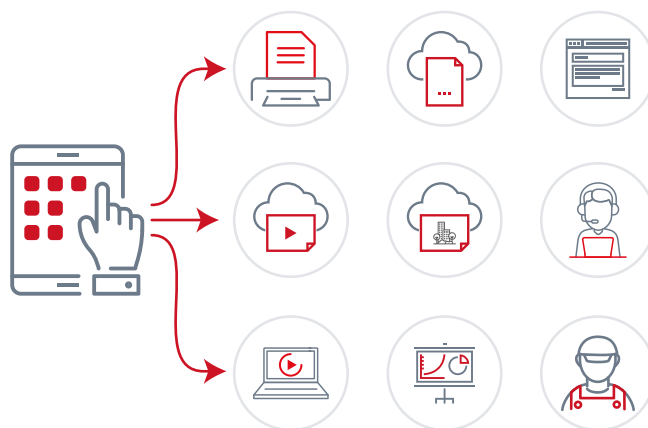

CYDEEN Field work support service

System configuration

Customers

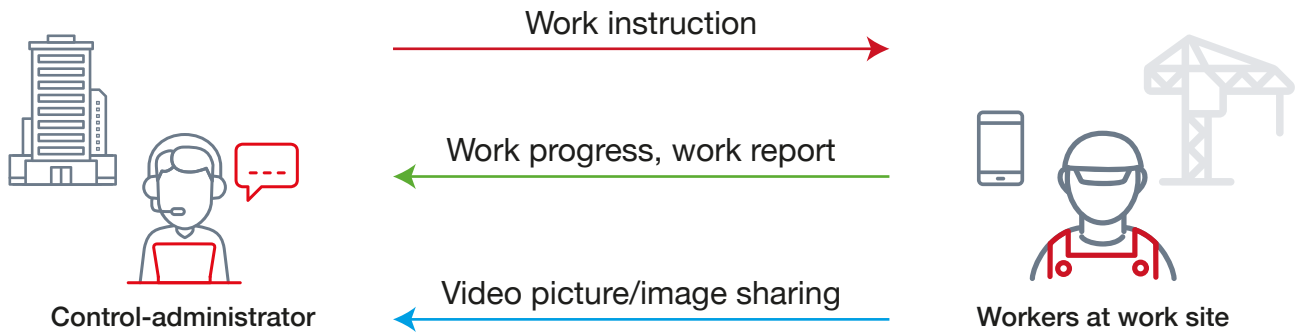

Support of grasping at work site and repair planning

Support of workload reduction and skill improvement

Hitachi Systems

Field work support service

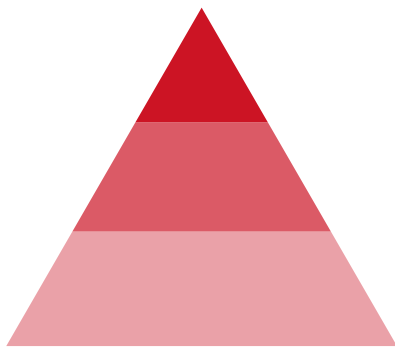

Accumulation of know-how at the work site

- Work history
- Motion video in the past
- Manuals
- Failure history
- Training materials
- etc.

©Hitachi Systems, Ltd. 1-2-1, Osaki, Shinagawa-ku, Tokyo, 141-8672 - Japan

©Hitachi Systems CBT Via Francesco P. da Cherso, 30 - 00143 - Roma - Italy